

Walker Industrial Park

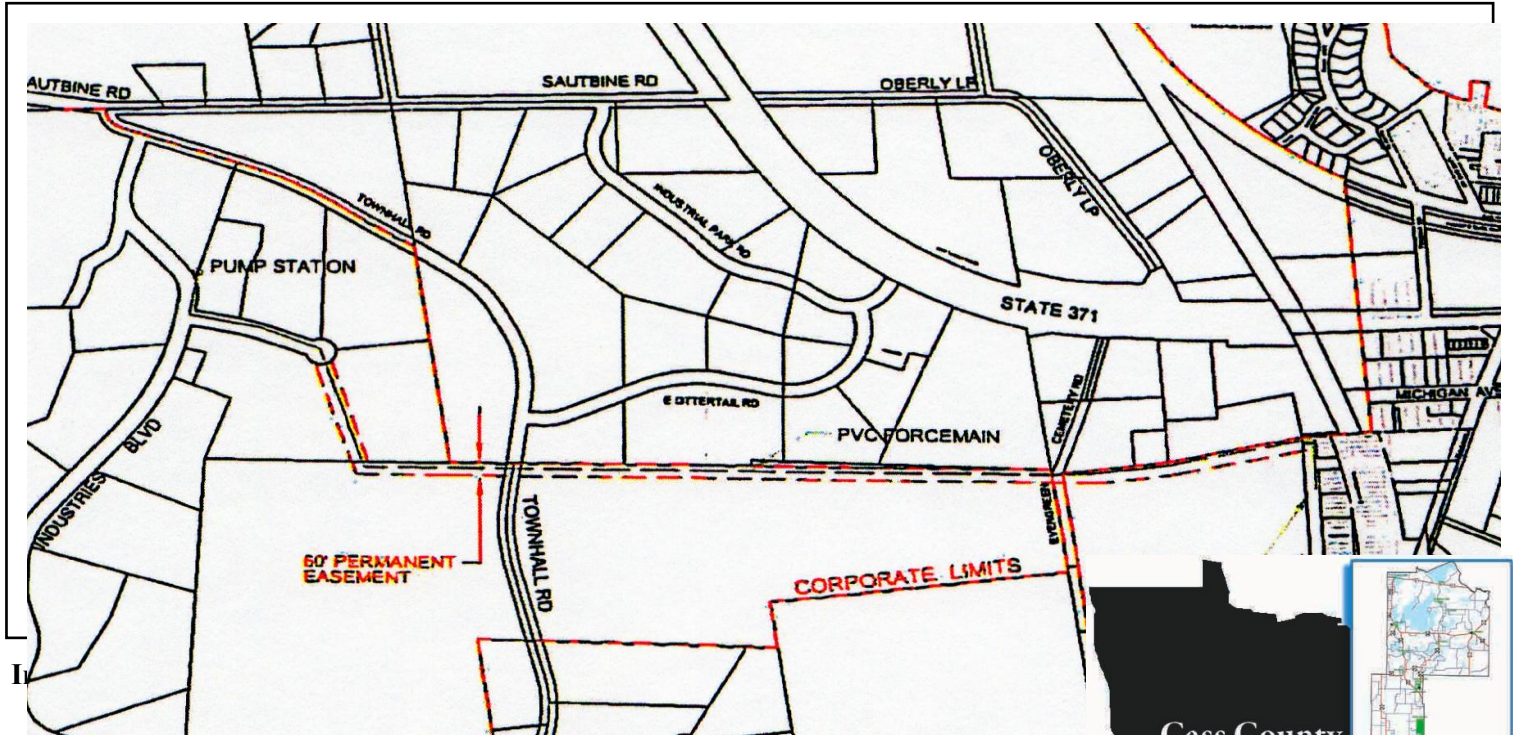

- Lot prices are negotiable
- Zoning: Commercial/Industrial
- 3 phase power from Beltrami Electric & MN Power
- Telecommunications from Arvig Communications Systems
- Road design: 5 ton industrial park road to 9 ton Sautbine Road
- City owned 4" PVC watermain to 2 wells & water treatment facility and 2" PVC pressure sewer
- Efficient transportation via Highway 371 to Brainerd/Bemidji

Qualified Workforce: Available at \$10/hour rate
Low commercial and industrial tax rate

Established Walker manufacturing businesses include:

- CavCom, Inc.
- Wilkening Fireplace, Inc.
- Next Innovations, LTD

Walker Community Highlights

Education: Thriving K-12 school system

Health Care: Major medical clinic, as well as dental and eye care providers

Recreation: Wide variety of outdoor recreation — biking, fishing & more!

The Time to Succeed is Now!
Financing is available.

Our Small Business Development Center assistance includes loan packaging with structured business and marketing plans, month-by-month cash flow projections, collateral analysis, and loan structuring including use of public funds and incentives.



Start a business, move your company or expand now to the city of Walker.
 Visit www.co.cass.mn.us/edc or call (218) 947-7522 to find out how.

The Cass County Economic Development Corporation (EDC) is a community, non-profit corporation providing confidential assistance to businesses wanting to start-up, locate or expand to Cass County, Minnesota.

PO Box 142, Backus, MN 56435